

# Maße / Dimensions

## Schieber Serie AT 200 mit Zylinder

## Knife gate valve series AT 200

## with pneumatic cylinder

### DN 350 - DN 700

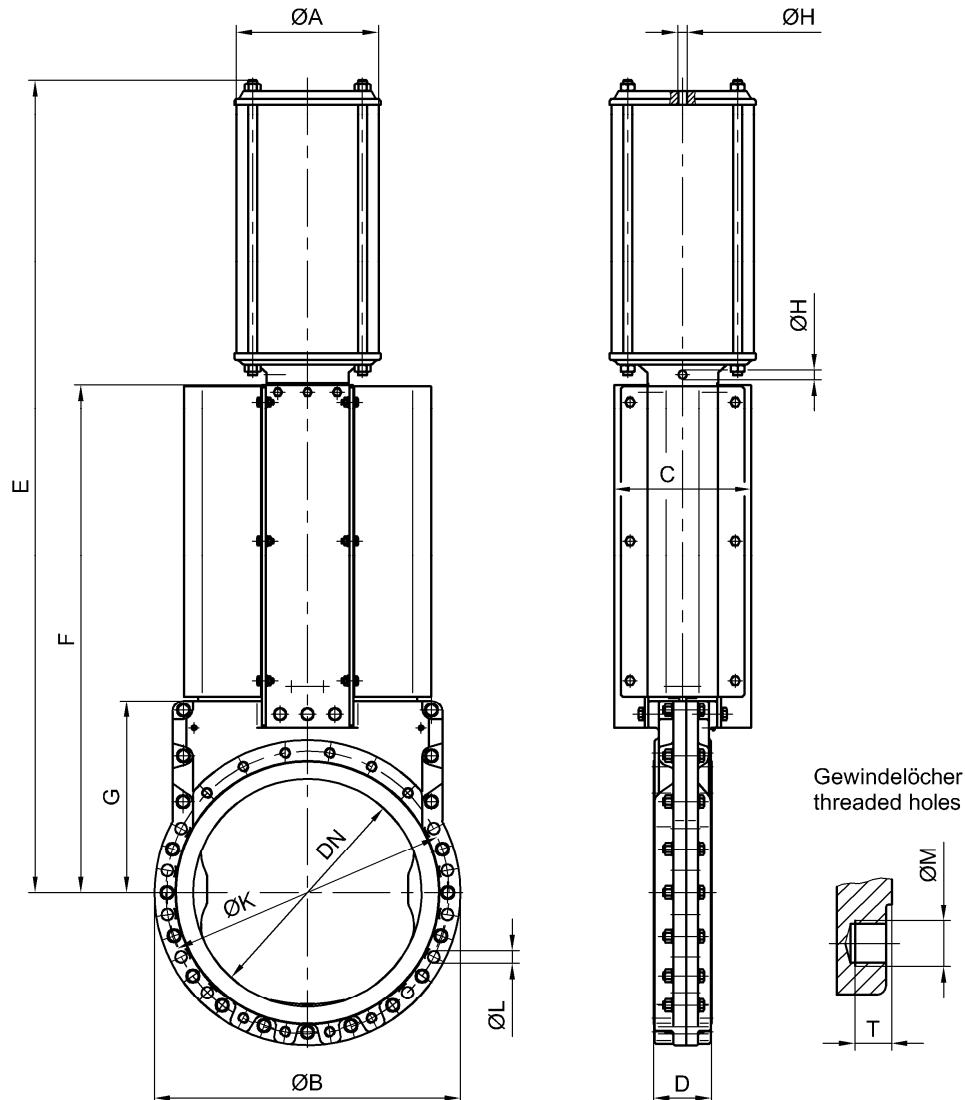

DN	NPS	P <sub>D</sub>	ØA	ØB	C	D	E	F	G	ØH	ØK	ØL	ØM	T	kg
350	14"	5	300	505	300	78	1420	901	330	R1/2"	460	8xØ22	8xM20	18	170
400	16"	4	300	565	300	102	1506	937	366	R1/2"	515	8xØ27	8xM24	26	205
450	18"	3	300	615	300	114	1701	1082	390	R1/2"	565	10xØ27	10xM24	26	245
500	20"	2,5	300	670	300	127	1782	1113	421	R1/2"	620	10xØ27	10xM24	26	290
600	24"	1	300	780	330	154	2085	1316	510	R1/2"	725	10xØ30	10xM27	35	425
700	28"	1	300	895	380	165	2417	1507	615	R1/2"	840	12xØ30	12xM27	39	695

P<sub>D</sub> [bar] = max. Differenzdruck bei Betätigung / max. differential pressure during operation

Steuerdruck für Zylinder / air pressure for cylinder: 6 bar

Max. Betriebsdruck:  
Max. working pressure:

DN	Druck / pressure
350-400	6,0 bar
450-700	4,0 bar